

REV A - JCG - 10/19/18 - UPDATED NOTES & ADDED BOLTS  
 REV B - JCG - 12/5/18 - UPDATED COVER SIZE  
 REV C - JCG - 6/25/19 - ADDED SAFETY LATCH  
 REV D - JCG - 6/18/2020 - UPDATED TO NEW METAL PART FILES

HINGED COVER W/ TREAD PLATE  
 P/N: 44-34-SPA-1 ~188 LBS

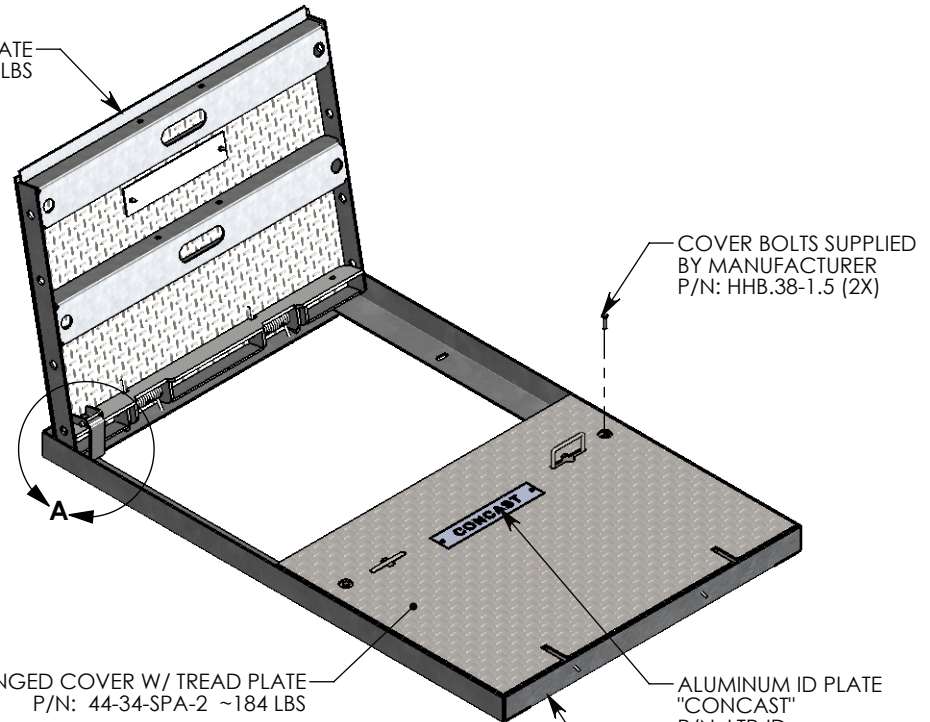
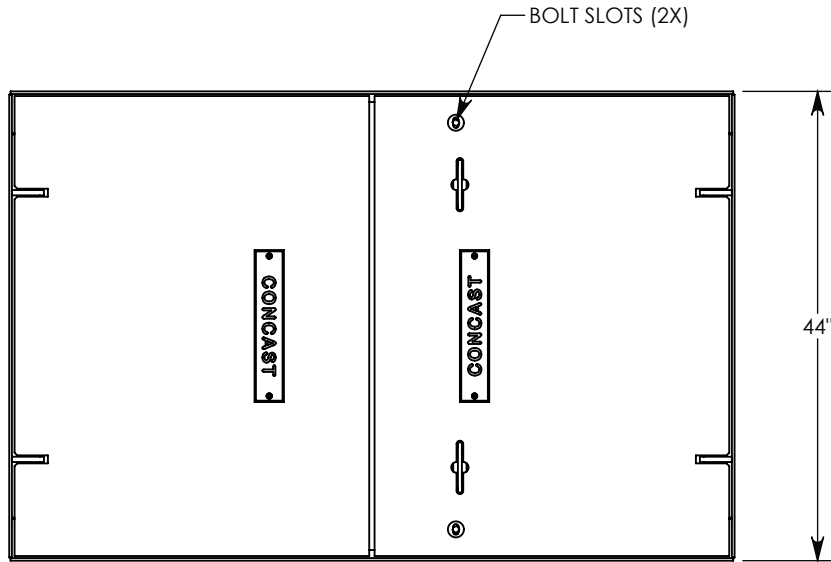

HINGED COVER W/ TREAD PLATE  
 P/N: 44-34-SPA-2 ~184 LBS

COVER BOLTS SUPPLIED  
 BY MANUFACTURER  
 P/N: HHB.38-1.5 (2X)

ALUMINUM ID PLATE  
 "CONCAST"  
 P/N: LTR-ID

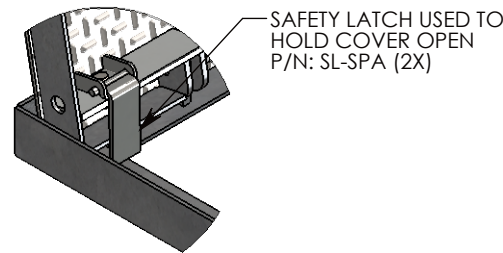

DETAIL A  
 SCALE 1 : 10

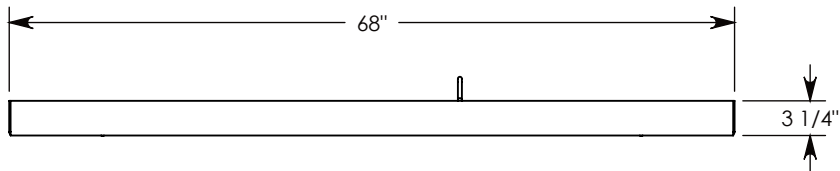

LIFT RING  
 SHOWN EXTENDED

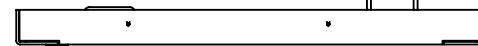

BOLT DOWN FRAME  
 P/N: 44-68-FRM-SPA ~110 LBS

NOTE 1: FOR ADDED SECURITY, PENTA HEAD (P/N: PTA.38-1.5) OR SURELOCK BOLTS (P/N: SL.38-1.25) CAN BE ADDED

AASHTO H-20 RATED – 32,000 LB. SINGLE AXLE LOAD

DRAWN BY: <b>JESSE GUTTING</b>	
CREATED DATE: <b>7/24/2016</b>	REVISION LEVEL: <b>D</b>
SAVED DATE: <b>6/18/2020</b>	SAVED BY: <b>jgutting</b>
WEIGHT: <b>484 LBS.</b>	MATERIAL: <b>WELDED GALV. STEEL</b>

1010 NORTH STAR DRIVE  
 P.O. BOX 69  
 ZUMBROTA, MN 55992-0069

DESCRIPTION: <b>SG SPRING-ASSISTED COVER W/BOLT-DOWN</b>		SHEET 1 OF 2
DIMENSIONS ARE IN INCHES TOLERANCES: FRACTIONAL: ± 1/8" ANGULAR: ± 2°	CONTACT INFORMATION: EMAIL: <a href="mailto:INFO@CONCASTINC.COM">INFO@CONCASTINC.COM</a> PHONE: (507) 732-4095 FAX: (507) 732-4094	
PART NUMBER: <b>44-68-SPA</b>		