

REV B - RLF - 5/15/17 - RENAMED DIVIDER BOARD  
 REV C - JCG - 5/15/17 - CHANGED BOLT AND NUT, REMOVED WASHERS  
 REV D - RAL - 5/2/18 - UPDATED TO ANCHOR PIN BOLTS  
 REV E - MKM - 5/11/18 - UPDATED MODEL & DRAWING  
 REV F - JCG - 10/21/2022 - UPDATED CARRIAGE BOLT DESCRIPTION

ITEM NO.	PART NUMBER	DESCRIPTION	QTY.
1	8001AB-4.5	PARTITION BOARD ALUM. L BRACKET	4
2	AN.38	3/8-16 UNC ACORN NUT	2
3	APB25-1.25	ANCHOR PIN BOLT	4
4	CRB.38-1.25-Z	3/8"-16 UNC X 1 1/4" LG CARRIAGE BOLT	2
5	FD15.7548	FIBERCRETE PARTITION BOARD	1

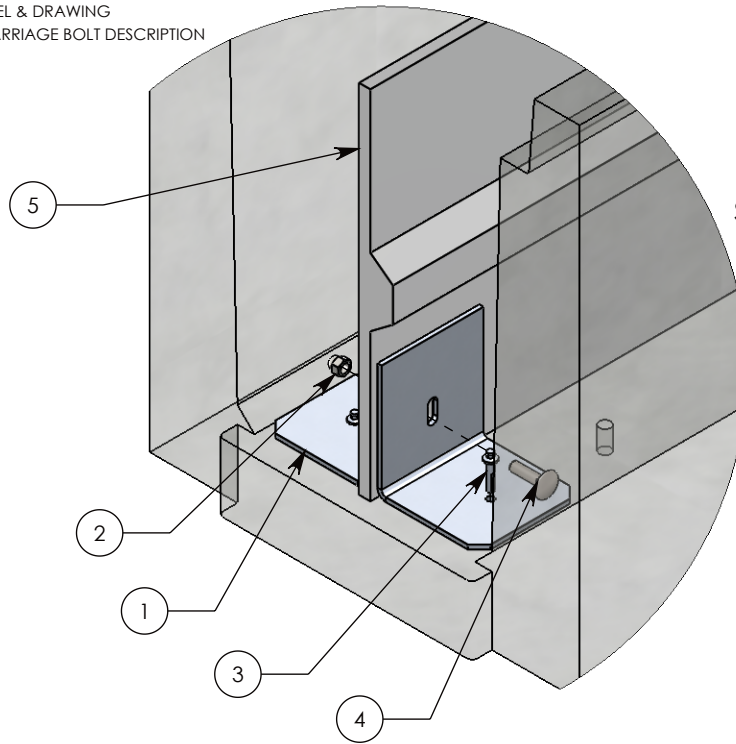

**DETAIL A**  
**SCALE 1 : 6**

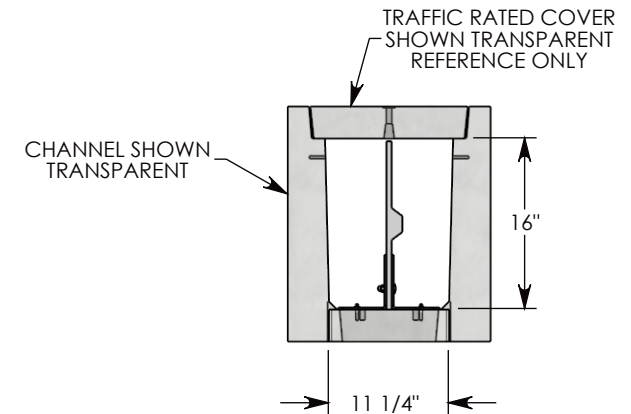
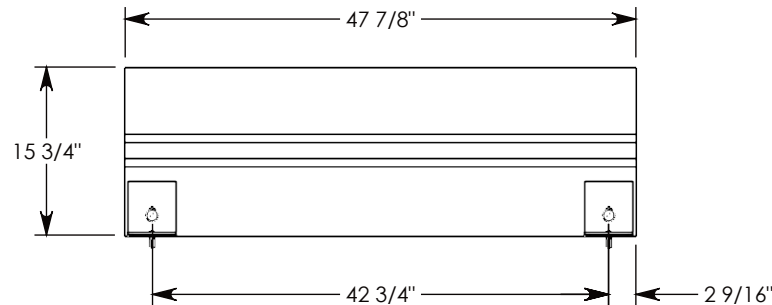
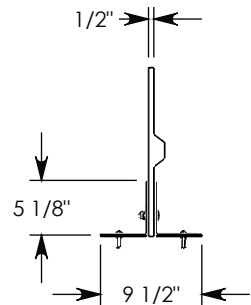
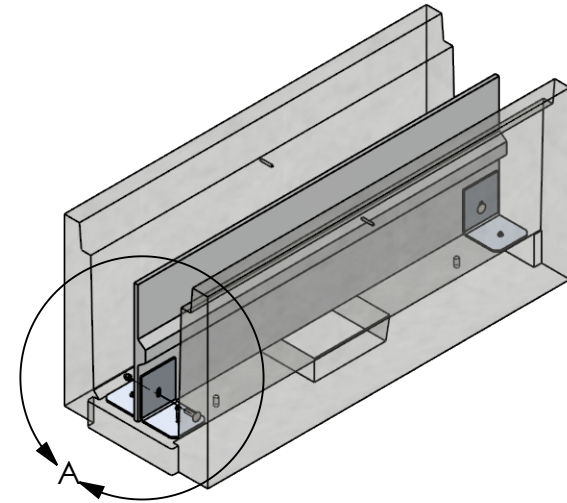

**NOTE 1:** ALL PARTS WILL BE SUPPLIED AT STANDARD LENGTH. FOR SPECIAL LENGTHS: FIELD CUT TO REQUIRED LENGTH  
**NOTE 2:** ANCHOR PIN BOLT-DOWN IS OPTIONAL. BOARD IS FREE-STANDING.

DRAWN BY: <b>ROBIN FLINT</b>	
CREATED DATE: <b>5/3/2012</b>	REVISION LEVEL: <b>F</b>
SAVED DATE: <b>10/21/2022</b>	SAVED BY: <b>jgutting</b>
WEIGHT: <b>39 LBS.</b>	MATERIAL: <b>NOTED</b>

**CONCAST**  
 1010 NORTH STAR DRIVE  
 P.O. BOX 69  
 ZUMBROTA, MN 55992-0069

DESCRIPTION: <b>PARTITION BOARD</b>		
DIMENSIONS ARE IN INCHES TOLERANCES: FRACTIONAL: $\pm 1/8"$ ANGULAR: $\pm 2^\circ$	CONTACT INFORMATION: EMAIL: <a href="mailto:INFO@CONCASTINC.COM">INFO@CONCASTINC.COM</a> PHONE: (507) 732-4095 FAX: (507) 732-4094	SHEET 1 OF 1
PART NUMBER: <b>800116-9.5</b>		