

REV A - JCG - 12/19/17 - INCREASED WIDTH AND INCREASED DRAFT
 REV B - JCG - 8/23/18 - UPDATED INSERTS

COVER ASSEMBLES ONTO 20" INSIDE WIDTH
 HEAVY TRAFFIC RATED CONCAST HT3 CHANNEL.

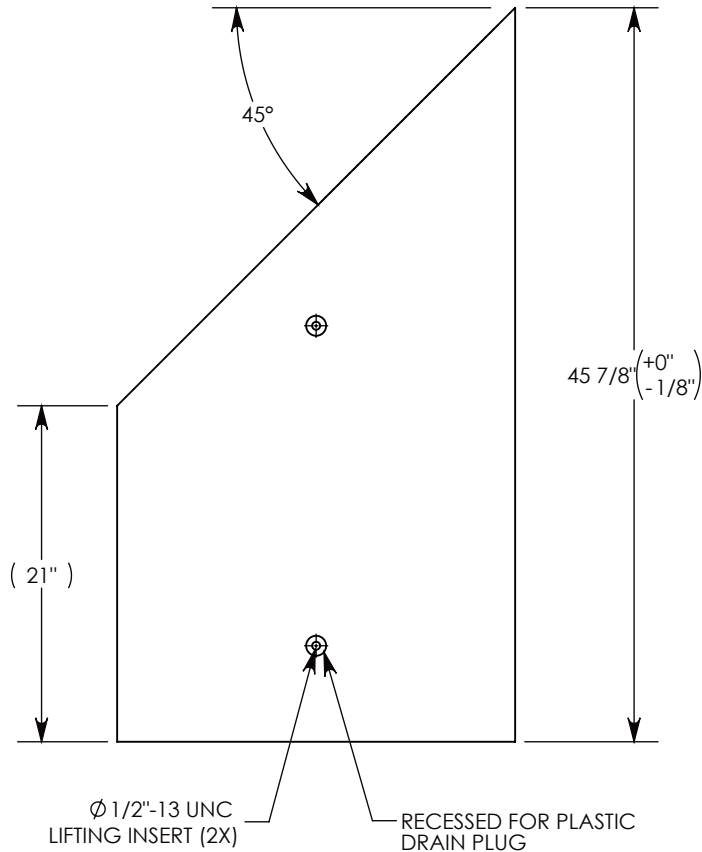

STEEL REINFORCED CONCRETE

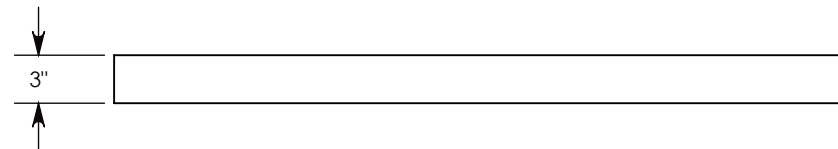
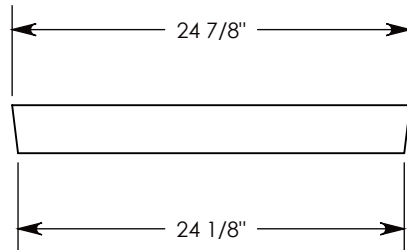
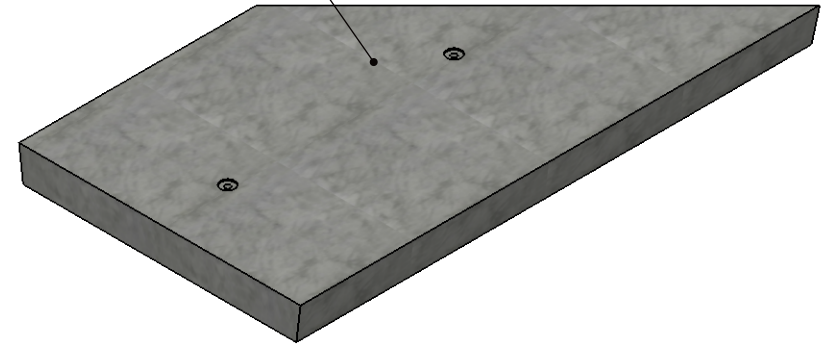

NOTE 1: MM#30032964

AASHTO H-20 RATED – 32,000 LB. SINGLE AXLE LOAD

DRAWN BY: ROBIN FLINT

DATE: 8/23/2018

REVISION LEVEL: B

WEIGHT:

201 LBS.

MATERIAL:

CONCRETE



DESCRIPTION:

HEAVY TRAFFIC COVER - 45 DEG. ANGLE

DIMENSIONS ARE IN INCHES
 TOLERANCES:
 FRACTIONAL: ± 1/8"
 ANGULAR: ± 2°

CONTACT INFORMATION:
 EMAIL: INFO@CONCASTINC.COM
 PHONE: (507) 732-4095
 FAX: (507) 732-4094

SHEET 1 OF 1

PART NUMBER:

8021HT3 45L