

FIBERCRETE[®] TRENCH SYSTEM

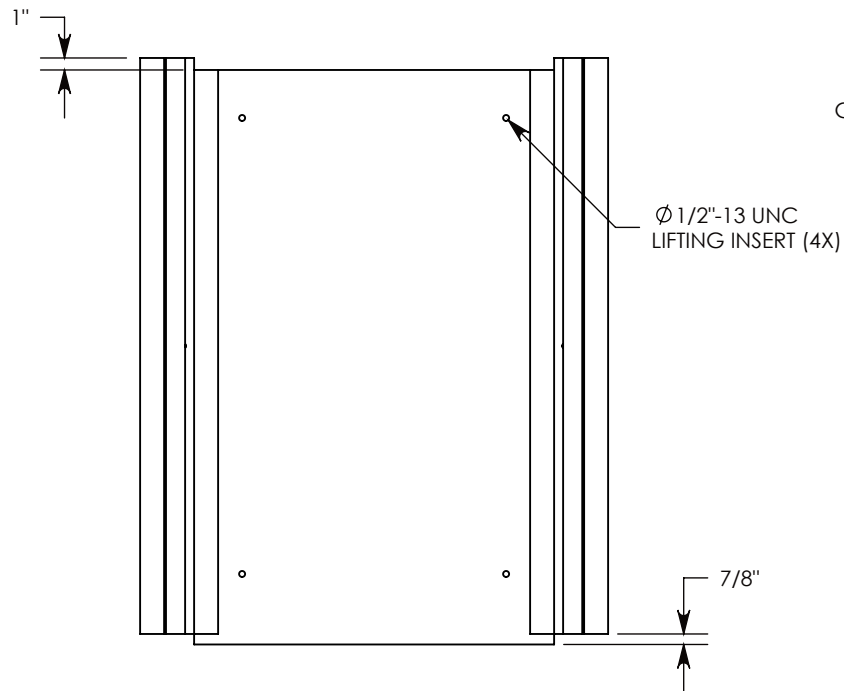

GALV. STEEL TOP RAIL (2X)

SOLID BOTTOM

STEEL REINFORCED CONCRETE

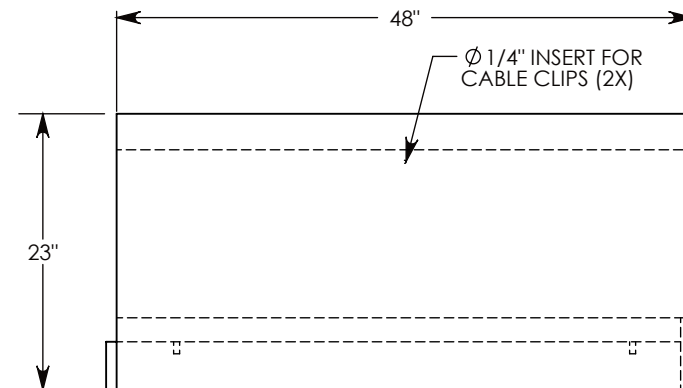
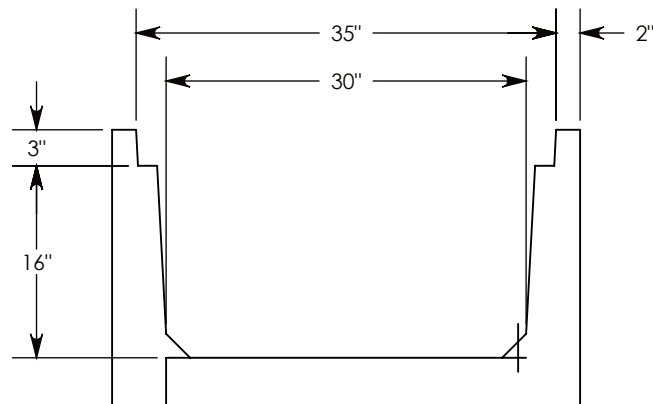
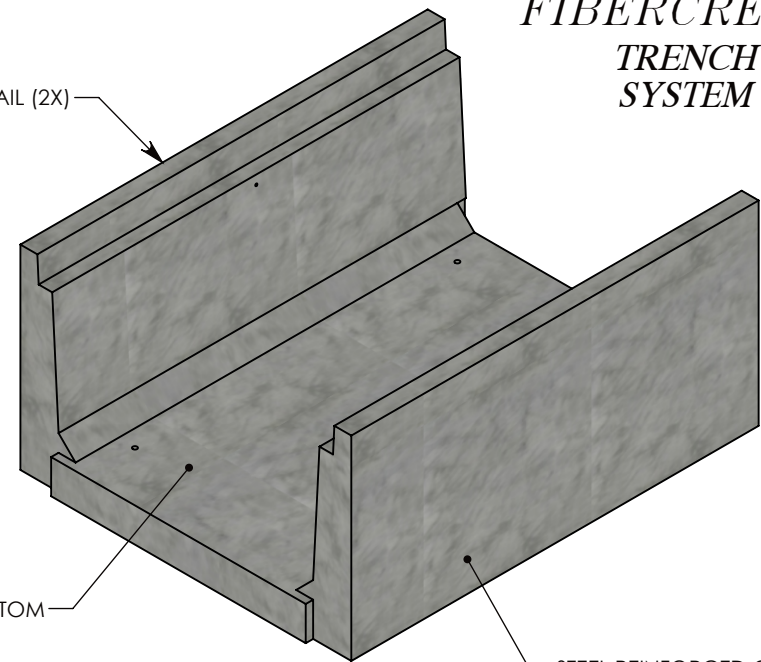

NOTE: FOR NON-STANDARD LENGTHS THE CHANNEL WILL BE SOLID BOTTOM
AND DESIGNATED WITH ITS CORRESPONDING LENGTH MEASUREMENT. IE: 803016LTSB 32"

H-10 RATED - 16,000 LB. PER AXLE LOAD

DRAWN BY: ROBIN FLINT

DATE: 3/29/2016

REVISION LEVEL: 0

WEIGHT:

1282 LBS.

MATERIAL:

NOTED

CONCAST
1010 NORTH STAR DRIVE
P.O. BOX 69
ZUMBROTA, MN 55992-0069

DESCRIPTION:

LIGHT TRAFFIC CHANNEL

DIMENSIONS ARE IN INCHES

TOLERANCES:
FRACTIONAL: ± 1/8"
ANGULAR: ± 2°

CONTACT INFORMATION:
EMAIL: INFO@CONCASTINC.COM
PHONE: (507) 732-4095
FAX: (507) 732-4094

SHEET 1 OF 1

PART NUMBER:

803016LTSB