

H-20 HEAVY TRAFFIC RATED
REINFORCED CONCRETE COVER WITH
SPRING-ASSISTED GALVANIZED
STEEL LID CAST-IN LID
P/N: 54-120-SA ~2,702 LBS.

STEEL REINFORCED CONCRETE
CONCRETE PULL BOX EXTENSION
P/N: PBEX-54-120-18 ~2878 LBS.

1/2-13 UNC X 1.5" LG HEX HD BOLT
P/N HHB.5-1.5 (8X)

PULL BOX JOINT TIE STRAP
P/N T-STRAP-1 (8X)

STEEL REINFORCED
CONCRETE PULL BOX
P/N: PBK02-54-120-54 ~8713 LBS.

5" DEEP KNOCKOUTS
CAST INTO ALL 4 SIDES

Ø .50-13 UNC INSERTS FOR LIFTING (4X)

ALUM ID PLATE "CONCAST"
P/N: LTR-ID

1/2-13 UNC X 1.5" LG PENTA HD BOLT
P/N PTA.5-1.5

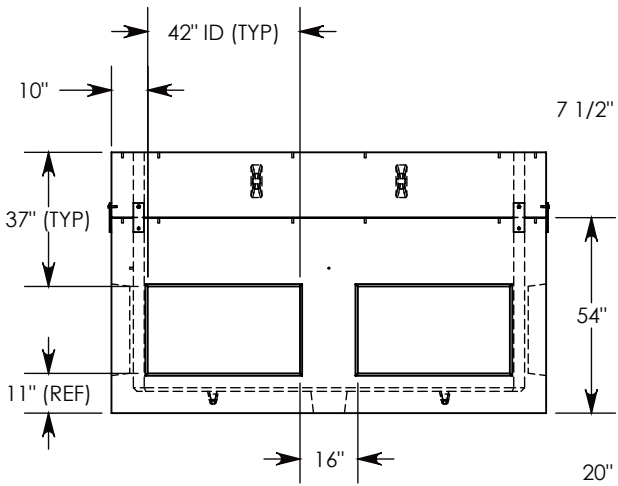
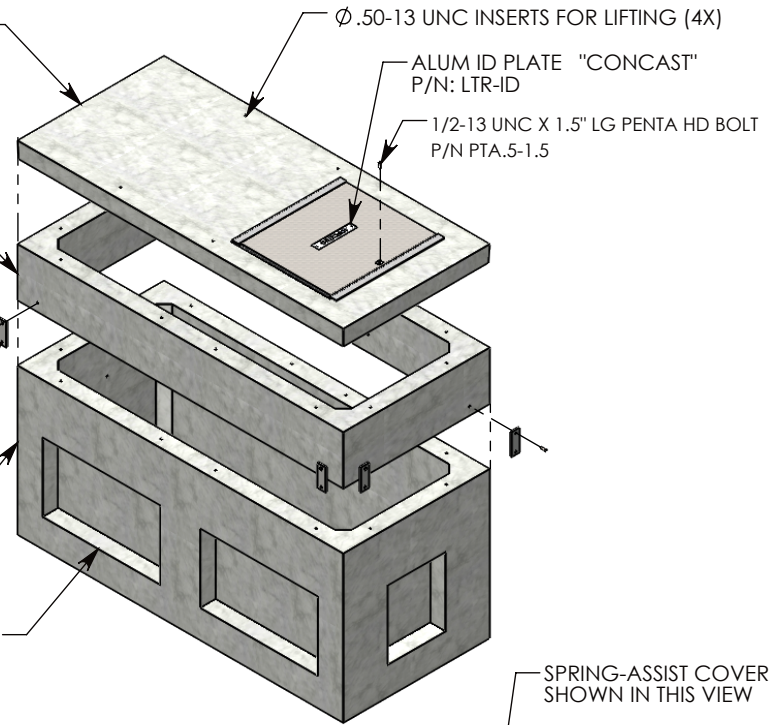

SIDE "A"

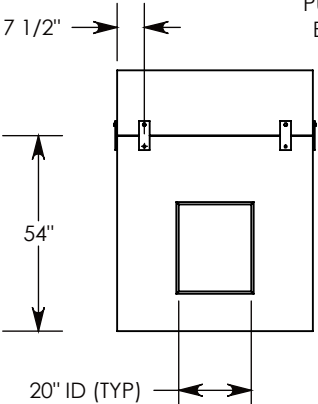

SIDE "B" (HLR)

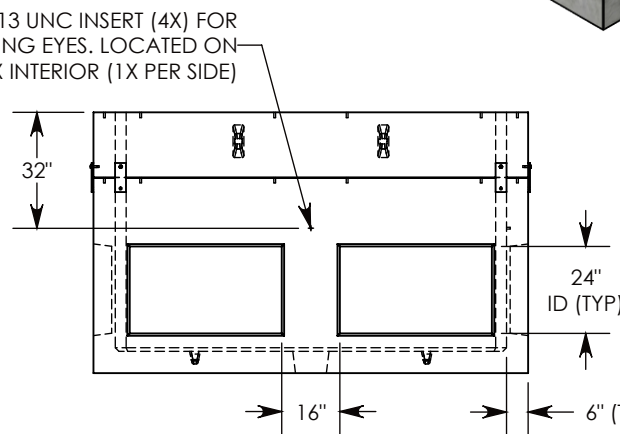

SIDE "C"

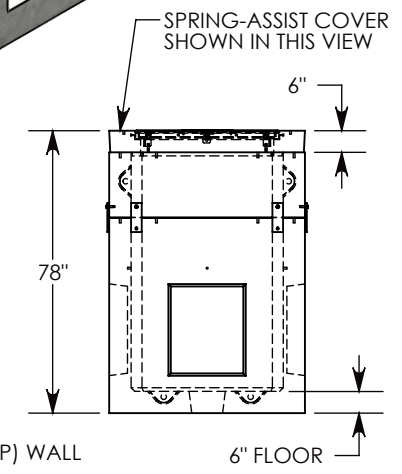

SIDE "D"

NOTE 1: FOR PVC SIZES SMALLER THAN 4", USE CONCAST RC41 (REDUCING COUPLER).

H-20 RATED - 32,000 LB. PER AXLE LOAD.

DRAWN BY: ROBIN FLINT

DATE: 1/1/2017

REVISION LEVEL: B

WEIGHT:

MATERIAL:

14322 LBS. W/COVER

NOTED

CONCAST
1010 NORTH STAR DRIVE
P.O. BOX 69
ZUMBROTA, MN 55992-0069

DESCRIPTION:

PULL BOX WITH SPRING-ASSIST RSG COVER

DIMENSIONS ARE IN INCHES

TOLERANCES:
FRACTIONAL: ± 1/8"
ANGULAR: ± 2°

CONTACT INFORMATION:

EMAIL: INFO@CONCASTINC.COM
PHONE: (507) 732-4095
FAX: (507) 732-4094

SHEET 1 OF 1

PART NUMBER:

PBKO2-54-120-78-SA