

COPOLYMER POLYPROPYLENE WITH
ASTM A 955 STAINLESS STEEL REINFORCEMENT BAR

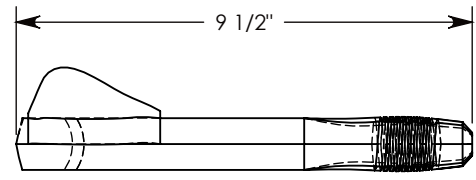
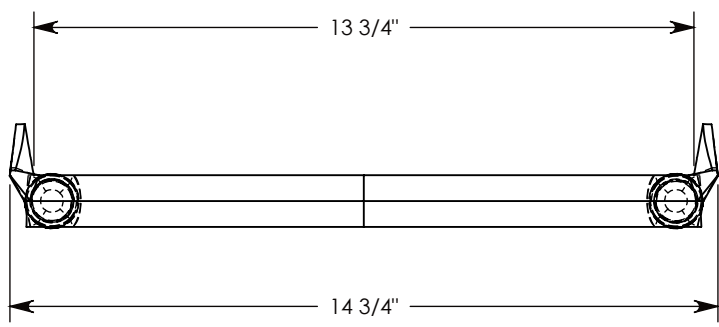

PREFORMED HOLE REQUIREMENTS:
(2) \varnothing 1.1" HOLES TAPERING TO \varnothing 7/8" TO 3-1/2" DEPTH
HOLES MUST BE PARALLEL

DRILLED HOLE REQUIREMENTS:
(2) \varnothing 1" HOLES DRILLED TO 3-3/4" MIN DEPTH
HOLES MUST BE PARALLEL
USE A 1" MASONRY DRILL BIT

NOTE 1: THIS STEP MEETS OR EXCEEDS ASTM C 478 AND OSHA STANDARDS WHEN PROPERLY INSTALLED.
NOTE 2: MINIMUM CONCRETE STRENGTH MUST BE 3,000 PSI.

DRAWN BY: MALACHI MLINAR	
DATE: 9/24/2018	REVISION LEVEL: A
WEIGHT: 1 LBS.	MATERIAL: PLASTIC



CONCAST
1010 NORTH STAR DRIVE
P.O. BOX 69
ZUMBROTA, MN 55992-0069

DESCRIPTION: POLYPROPYLENE STEP - STAINLESS STEEL CORE		
DIMENSIONS ARE IN INCHES TOLERANCES: FRACTIONAL: \pm 1/8" ANGULAR: \pm 2°	CONTACT INFORMATION: EMAIL: INFO@CONCASTINC.COM PHONE: (507) 732-4095 FAX: (507) 732-4094	SHEET 1 OF 1
PART NUMBER: STP-2		