

REV. A - JCG - 10/22/18 - ADDED BOLT & UPDATED NOTES  
 REV. B - MKM - 12/5/19 - ADDED DIMS TO LOCATE OPENING

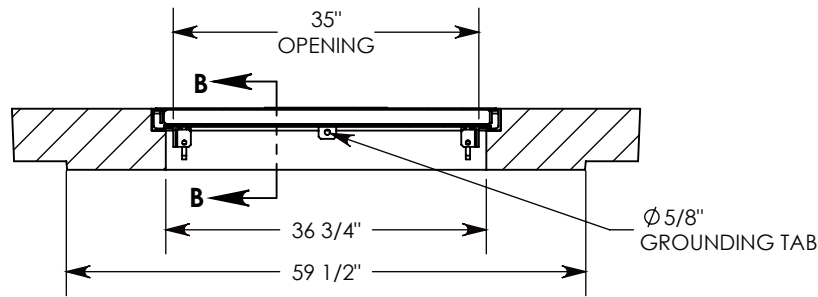

SECTION A-A

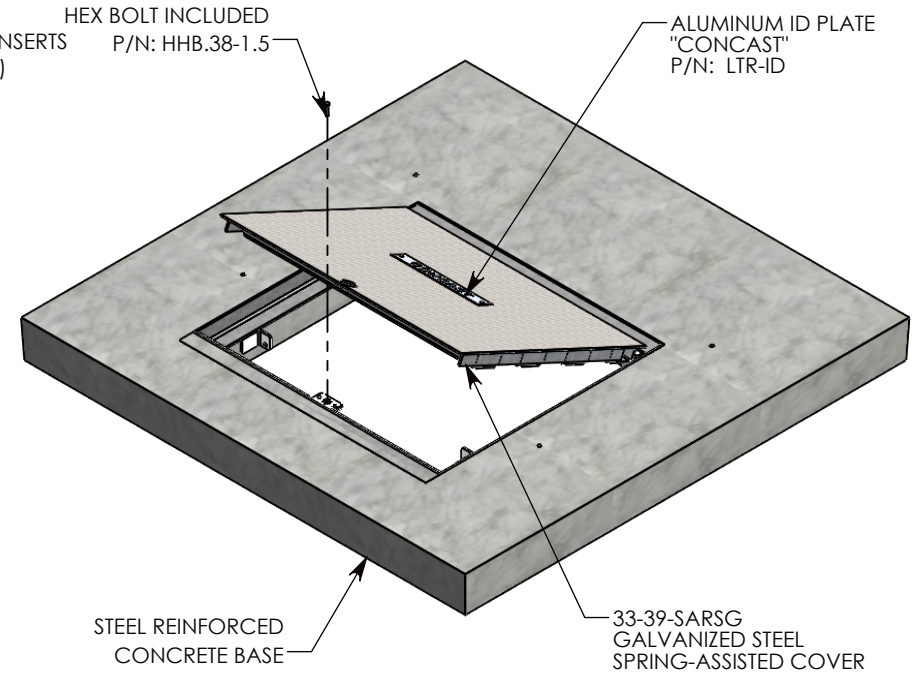
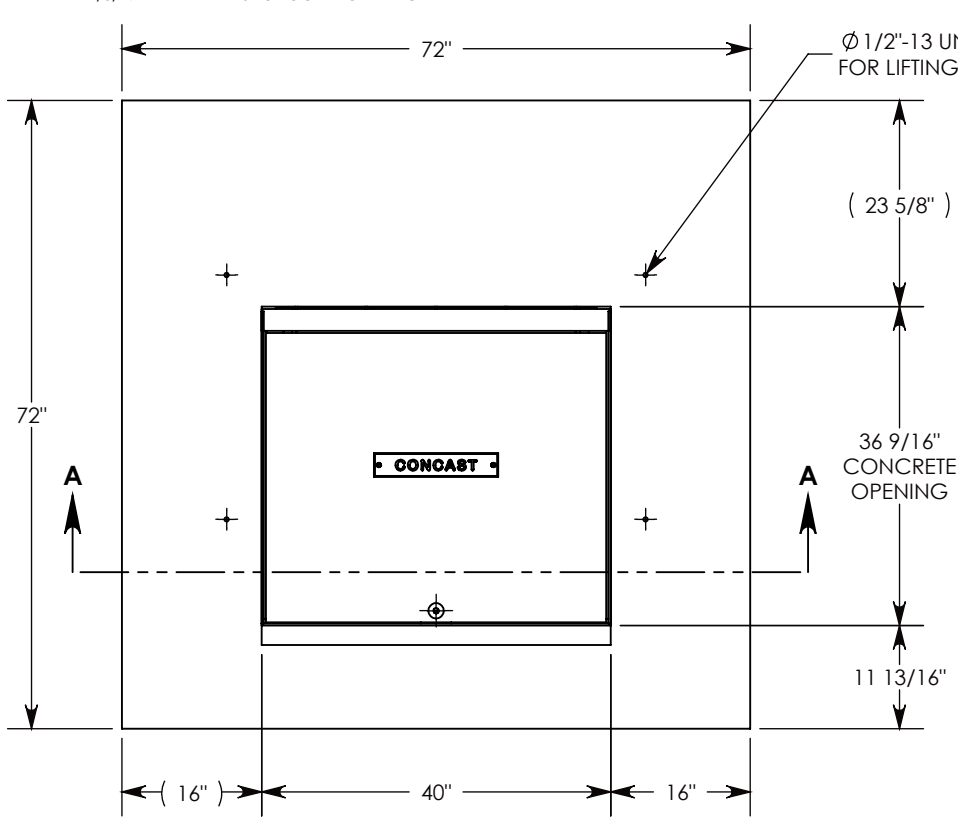
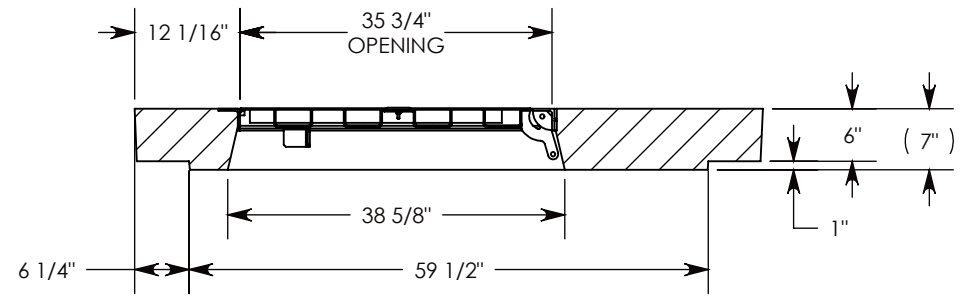

SECTION B-B

NOTE 1: FOR ADDED SECURITY, PENTA HEAD (P/N: PTA.38-1.5) OR SURELOCK BOLTS (P/N: SL.38-1.5) CAN BE ADDED

AASHTO H-20 RATED - 32,000 LB. SINGLE AXLE LOAD

<b>DRAWN BY:</b> ROBIN FLINT	
<b>CREATED DATE:</b> 4/20/2018	<b>REVISION LEVEL:</b> B
<b>SAVED DATE:</b> 12/5/2019	<b>SAVED BY:</b> mmlinar
<b>WEIGHT:</b> 2248 LBS.	<b>MATERIAL:</b> NOTED

1010 NORTH STAR DRIVE  
 P.O. BOX 69  
 ZUMBROTA, MN 55992-0069

<b>DESCRIPTION:</b> SPRING ASSISTED RSG PULL BOX COVER	
DIMENSIONS ARE IN INCHES TOLERANCES: FRACTIONAL: ± 1/8" ANGULAR: ± 2°	CONTACT INFORMATION: EMAIL: INFO@CONCASTINC.COM PHONE: (507) 732-4095 FAX: (507) 732-4094
<b>PART NUMBER:</b> 72-72-SA	