

REV.A - JCG - 12-19-2017 - INCREASED WIDTH AND INCREASED DRAFT  
 REV B: -TCJ - 8/22/2018 - UPDATED TO RECESSED INSERT

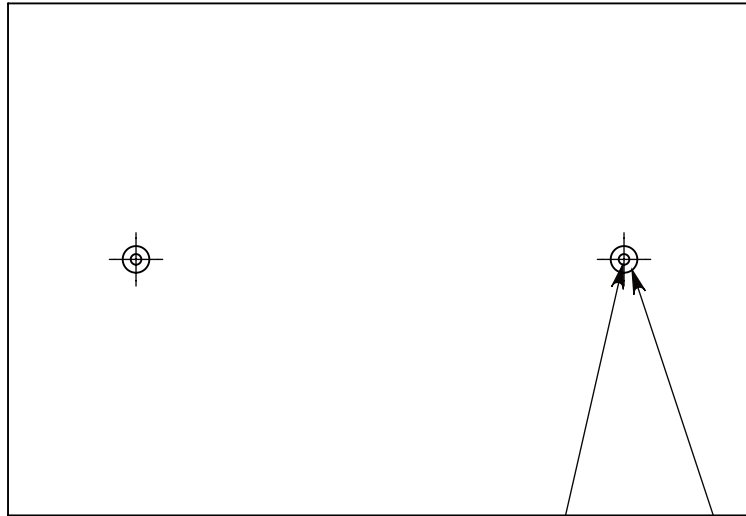

2X Ø 1/2"-13 UNC  
LIFTING INSERT

RECESSED FOR PLASTIC  
PLUG INSERT

STEEL REINFORCED CONCRETE

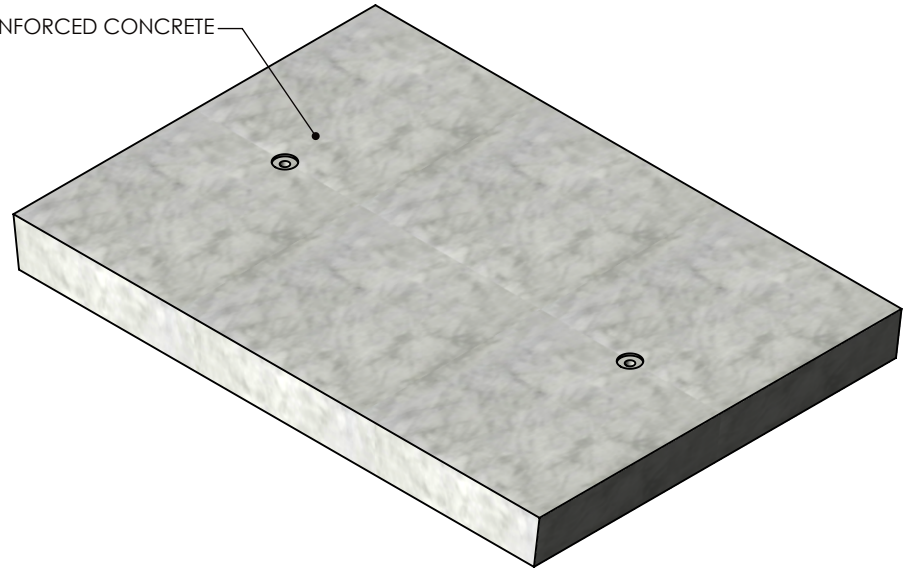

COVER ASSEMBLES ONTO 30" INSIDE WIDTH  
HEAVY TRAFFIC RATED CONCAST HT3 CHANNEL.

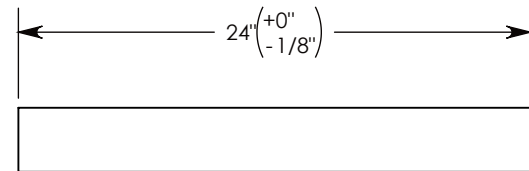
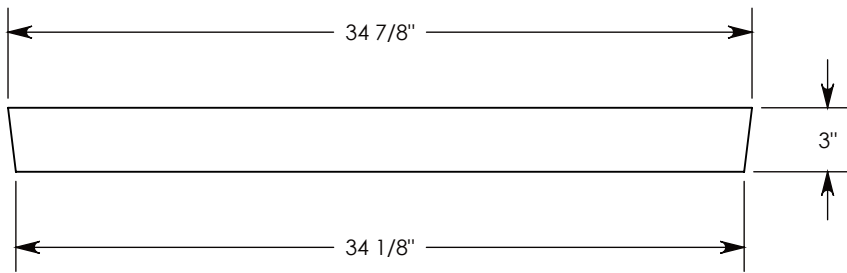

AASHTO H-20 RATED – 32,000 LB. SINGLE AXLE LOAD

**DRAWN BY: ROBIN FLINT**

**DATE: 8/23/2018**

**REVISION LEVEL: B**

**WEIGHT:**

**203 LBS.**

**MATERIAL:**

**CONCRETE**



1010 NORTH STAR DRIVE  
 P.O. BOX 69  
 ZUMBROTA, MN 55992-0069

**DESCRIPTION:**

**HEAVY TRAFFIC COVER**

DIMENSIONS ARE IN INCHES  
 TOLERANCES:  
 FRACTIONAL: ± 1/8"  
 ANGULAR: ± 2°

CONTACT INFORMATION:  
 EMAIL: INFO@CONCASTINC.COM  
 PHONE: (507) 732-4095  
 FAX: (507) 732-4094

SHEET 1 OF 1

**PART NUMBER:**

**8031HT3 24"**