

REV. A - SIC - 11/12/2021 - UPDATED TITLEBLOCK; REVISED CABLE RISER DESIGN PER ALUMINUM PRODUCT VENDOR; REPLACED RIGHT VIEW WITH SECTION A-A; REPLACED REAR VIEW WITH AUXILIARY VIEW B-B; REMOVED FIBERCRETE LOGO  
 REV. B - SIC - 12/9/2021 - ADDED EXTENSION MOUNTING HOLES AND ADJUSTED CABLE RISER WALL FLANGE HEIGHT TO ACCOMMODATE

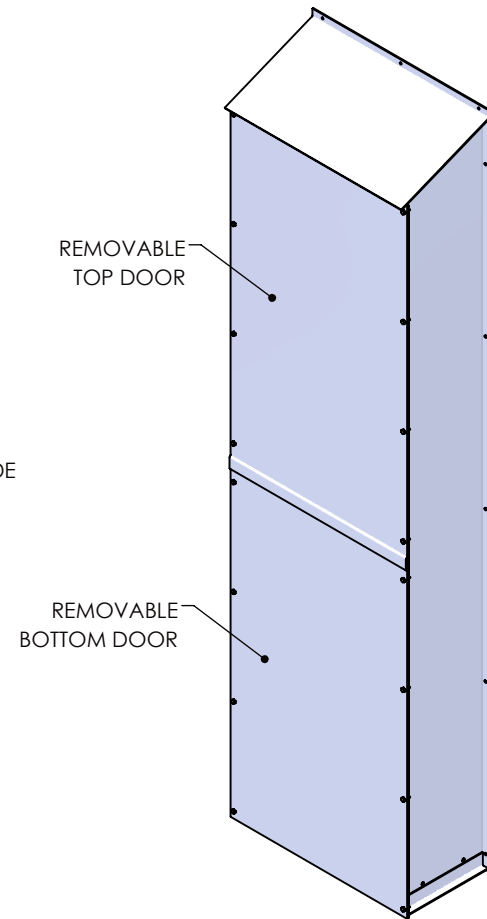

<b>DRAWN BY: ROBIN FLINT</b>	
<b>CREATED DATE: 4/29/2011</b>	<b>REVISION LEVEL: B</b>
<b>SAVED DATE: 12/10/2021</b>	<b>SAVED BY: scallahan</b>
<b>WEIGHT: 76 LBS.</b>	<b>MATERIAL: WELDED ALUMINUM</b>

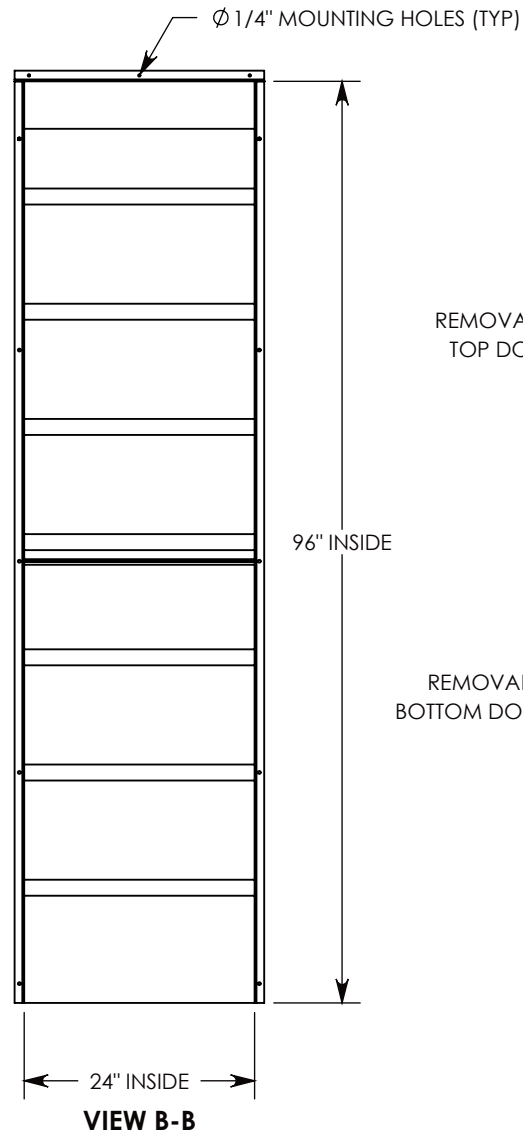
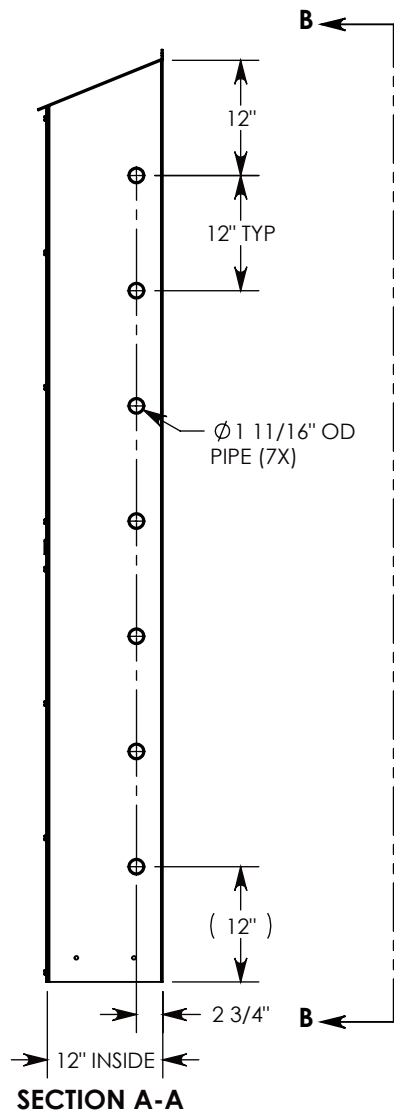
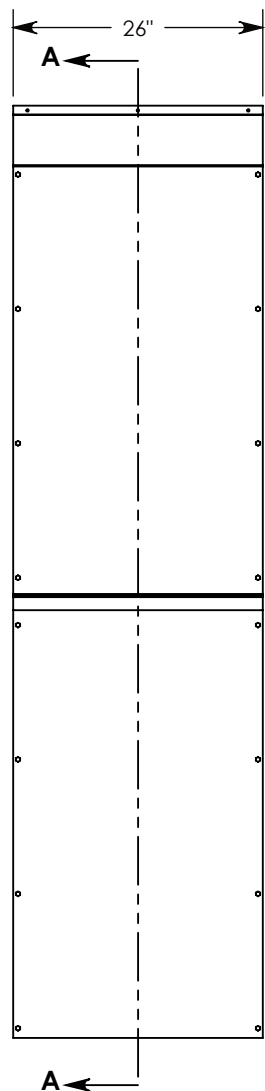

**CONCAST**  
 1010 NORTH STAR DRIVE  
 P.O. BOX 69  
 ZUMBROTA, MN 55992-0069

<b>DESCRIPTION:</b> <b>ALUMINUM CABLE RISER</b>		SHEET 1 OF 1
DIMENSIONS ARE IN INCHES TOLERANCES: FRACTIONAL: ± 1/8" ANGULAR: ± 2°	CONTACT INFORMATION: EMAIL: INFO@CONCASTINC.COM PHONE: (507) 732-4095 FAX: (507) 732-4094	
<b>PART NUMBER:</b> <b>CR-24-12-96</b>		